



PM486FP 1.91" (48.6MM) Diameter 24V DC Motorized Roller

Features:

- 50% more torque than the PM486FS.
- Ideal for incline and belt conveyor applications.
- DC brushless motor provides long life.
- 7/16" hex (threaded) shaft standard.

DIMENSIONS

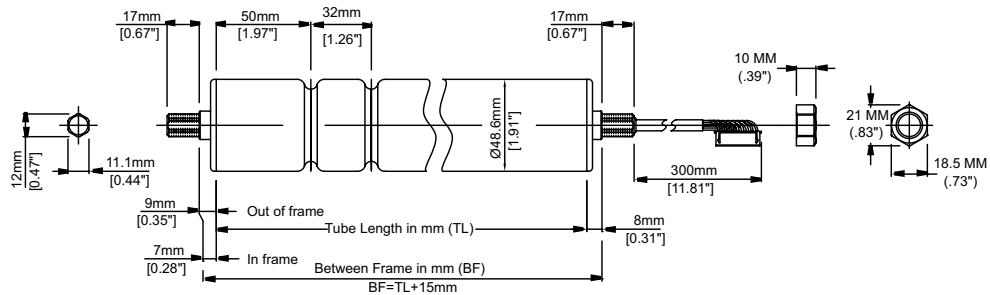

Standard Threaded Hex Shafts with Grooved Tube

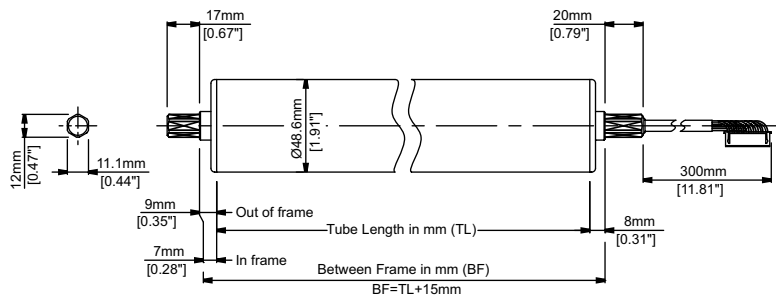

JR-(Yoke Style) Hex Shafts/Straight Tube

OPERATING CHARACTERISTICS WITH CB-016S2 DRIVER CARD

3-stage			PM486FP-15							
DIP	Switch		EXT		Speed (ft/min) ± 5%		Tangential Force (lb)	Torque (lb-in)	Current (A)	
	Rotary		Voltage(V)	No-Load	Rated	Starting	Starting	Starting	No-Load	Rated
ON	9		9.75 ± 0.2	54.8	48.6	102.4	98.2	4.0	0.9	2.2
	8		9.25 ± 0.2	51.8	48.6	102.4	98.2	4.0	0.9	2.1
	7		8.75 ± 0.2	49.5	49.5	102.4	98.2	4.0	0.8	2.0
	6		8.25 ± 0.2	47.2	47.2	102.4	98.2	4.0	0.8	1.9
	5		7.75 ± 0.2	44.9	44.9	102.4	98.2	4.0	0.7	1.8
	4		7.25 ± 0.2	42.7	42.7	102.4	98.2	4.0	0.7	1.8
	3		6.75 ± 0.2	37.7	37.7	102.4	98.2	4.0	0.6	1.7
	2		6.25 ± 0.2	35.4	35.4	102.4	98.2	4.0	0.6	1.7
	1		5.75 ± 0.2	33.1	33.1	102.4	98.2	4.0	0.5	1.6
0		5.25 ± 0.2	30.8	30.8	102.4	98.2	4.0	0.5	1.6	
OFF	9		4.75 ± 0.2	28.2	28.2	102.4	98.2	4.0	0.4	1.5
	8		4.25 ± 0.2	25.9	25.9	102.4	98.2	4.0	0.4	1.5
	7		3.75 ± 0.2	23.6	23.6	102.4	98.2	4.0	0.4	1.4
	6		3.25 ± 0.2	21.3	21.3	102.4	98.2	4.0	0.4	1.4
	5		2.75 ± 0.2	19.0	19.0	102.4	98.2	4.0	0.3	1.3
	4		2.25 ± 0.2	16.4	16.4	102.4	98.2	4.0	0.3	1.3
	3		1.75 ± 0.2	14.1	14.1	102.4	98.2	4.0	0.3	1.2
	2		1.25 ± 0.2	11.8	11.8	102.4	98.2	4.0	0.2	1.2
	1		0.75 ± 0.2	9.5	9.5	102.4	98.2	4.0	0.2	1.1
0		0.25 ± 0.2	7.2	7.2	102.4	98.2	4.0	0.2	1.1	
2-stage			PM486FP-55							
DIP	Switch		EXT		Speed (ft/min) ± 5%		Tangential Force (lb)	Torque (lb-in)	Current (A)	
	Rotary		Voltage(V)	No-Load	Rated	Starting	Starting	Starting	No-Load	Rated
ON	9		9.75 ± 0.2	207.0	183.7	30.9	29.2	4.0	0.9	2.2
	8		9.25 ± 0.2	195.9	183.7	30.9	29.2	4.0	0.9	2.1
	7		8.75 ± 0.2	187.0	187.0	30.9	29.2	4.0	0.8	2.0
	6		8.25 ± 0.2	178.1	178.1	30.9	29.2	4.0	0.8	1.9
	5		7.75 ± 0.2	169.2	169.2	30.9	29.2	4.0	0.7	1.8
	4		7.25 ± 0.2	160.4	160.4	30.9	29.2	4.0	0.7	1.8
	3		6.75 ± 0.2	142.4	142.4	30.9	29.2	4.0	0.6	1.7
	2		6.25 ± 0.2	133.5	133.5	30.9	29.2	4.0	0.6	1.7
	1		5.75 ± 0.2	124.6	124.6	30.9	29.2	4.0	0.5	1.6
0		5.25 ± 0.2	115.8	115.8	30.9	29.2	4.0	0.5	1.6	
OFF	9		4.75 ± 0.2	107.0	107.0	30.9	29.2	4.0	0.4	1.5
	8		4.25 ± 0.2	98.1	98.1	30.9	29.2	4.0	0.4	1.5
	7		3.75 ± 0.2	88.9	88.9	30.9	29.2	4.0	0.4	1.4
	6		3.25 ± 0.2	80.0	80.0	30.9	29.2	4.0	0.4	1.4
	5		2.75 ± 0.2	71.2	71.2	30.9	29.2	4.0	0.3	1.3
	4		2.25 ± 0.2	62.3	62.3	30.9	29.2	4.0	0.3	1.3
	3		1.75 ± 0.2	53.5	53.5	30.9	29.2	4.0	0.3	1.2
	2		1.25 ± 0.2	44.6	44.6	30.9	29.2	4.0	0.2	1.2
	1		0.75 ± 0.2	35.8	35.8	30.9	29.2	4.0	0.2	1.1
0		0.25 ± 0.2	26.6	26.6	30.9	29.2	4.0	0.2	1.1	
1-stage			PM486FP-100							
DIP	Switch		EXT		Speed (ft/min) ± 5%		Tangential Force (lb)	Torque (lb-in)	Current (A)	
	Rotary		Voltage(V)	No-Load	Rated	Starting	Starting	Starting	No-Load	Rated
ON	9		9.75 ± 0.2	404.5	250.1	10.0	9.7	4.0	0.3	2.6
	8		9.25 ± 0.2	404.5	250.1	10.0	9.7	4.0	0.3	2.6
	7		8.75 ± 0.2	404.5	250.1	10.0	9.7	4.0	0.3	2.6
	6		8.25 ± 0.2	404.5	250.1	10.0	9.7	4.0	0.3	2.6
	5		7.75 ± 0.2	404.5	250.1	10.0	9.7	4.0	0.3	2.6
	4		7.25 ± 0.2	404.5	250.1	10.0	9.7	4.0	0.3	2.6
	3		6.75 ± 0.2	404.5	250.1	10.0	9.7	4.0	0.3	2.6
	2		6.25 ± 0.2	404.5	250.1	10.0	9.7	4.0	0.3	2.6
	1		5.75 ± 0.2	404.5	250.1	10.0	9.7	4.0	0.3	2.6
0		5.25 ± 0.2	404.5	250.1	10.0	9.7	4.0	0.3	2.6	
OFF	9		4.75 ± 0.2	404.5	250.1	10.0	9.7	4.0	0.3	2.6
	8		4.25 ± 0.2	404.5	250.1	10.0	9.7	4.0	0.3	2.6
	7		3.75 ± 0.2	404.5	250.1	10.0	9.7	4.0	0.3	2.6
	6		3.25 ± 0.2	364.2	251.3	10.0	9.7	4.0	0.3	2.6
	5		2.75 ± 0.2	323.8	251.3	10.0	9.7	4.0	0.3	2.6
	4		2.25 ± 0.2	283.4	250.1	10.0	9.7	4.0	0.2	2.6
	3		1.75 ± 0.2	242.8	242.5	10.0	9.7	4.0	0.2	2.5
	2		1.25 ± 0.2	202.4	202.4	10.0	9.7	4.0	0.2	2.3
	1		0.75 ± 0.2	162.0	162.1	10.0	9.7	4.0	0.2	2.1
0		0.25 ± 0.2	121.4	120.7	10.0	9.7	4.0	0.2	1.9	

Other speeds available.

Shaded area designates speeds where stable speed function is inoperative.

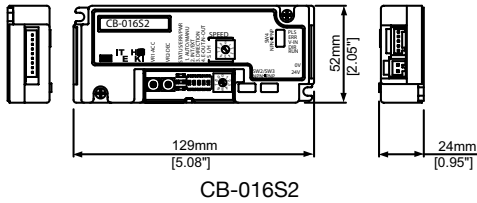

CB-016S2

OPERATING CHARACTERISTICS WITH HB-510 ZPA HYBRID CARD

3-stage		PM486FP-15						
Rotary Switch	EXT Voltage (V)	Speed (ft/min) ± 5%		Tangential Force (lb)	Torque (lb-in)	Current (A)		
		No-Load	Rated	Starting	Starting	Starting	No-Load	Rated
9	9.5 ± 0.2	54.1	48.2	99.6	95.6	4.0	0.9	2.2
8	8.5 ± 0.2	51.8	47.9	99.6	95.6	4.0	0.8	2.1
7	7.5 ± 0.2	47.2	47.2	99.6	95.6	4.0	0.6	1.9
6	6.5 ± 0.2	42.7	42.7	99.6	95.6	4.0	0.7	1.8
5	5.5 ± 0.2	37.7	37.7	99.6	95.6	4.0	0.5	1.7
4	4.5 ± 0.2	33.1	33.1	99.6	95.6	4.0	0.5	1.6
3	3.5 ± 0.2	28.2	28.2	99.6	95.6	4.0	0.4	1.5
2	2.5 ± 0.2	23.6	23.6	99.6	95.6	4.0	0.4	1.4
1	1.5 ± 0.2	19.0	19.0	99.6	95.6	4.0	0.4	1.3
0	0.5 ± 0.2	14.1	14.1	99.6	95.6	4.0	0.2	1.2

2-stage		PM486FP-55						
Rotary Switch	EXT Voltage (V)	Speed (ft/min) ± 5%		Tangential Force (lb)	Torque (lb-in)	Current (A)		
		No-Load	Rated	Starting	Starting	Starting	No-Load	Rated
9	9.5 ± 0.2	204.4	181.4	30.0	28.3	4.0	0.9	2.2
8	8.5 ± 0.2	195.9	181.1	30.0	28.3	4.0	0.8	2.1
7	7.5 ± 0.2	178.1	178.1	30.0	28.3	4.0	0.6	1.9
6	6.5 ± 0.2	160.4	160.4	30.0	28.3	4.0	0.7	1.8
5	5.5 ± 0.2	142.4	142.4	30.0	28.3	4.0	0.5	1.7
4	4.5 ± 0.2	124.7	124.7	30.0	28.3	4.0	0.5	1.6
3	3.5 ± 0.2	107.0	107.0	30.0	28.3	4.0	0.4	1.5
2	2.5 ± 0.2	88.9	88.9	30.0	28.3	4.0	0.4	1.4
1	1.5 ± 0.2	71.2	71.2	30.0	28.3	4.0	0.4	1.3
0	0.5 ± 0.2	53.5	53.5	30.0	28.3	4.0	0.2	1.2

1-stage		PM486FP-100						
Rotary Switch	EXT Voltage (V)	Speed (ft/min) ± 5%		Tangential Force (lb)	Torque (lb-in)	Current (A)		
		No-Load	Rated	Starting	Starting	Starting	No-Load	Rated
9	9.5 ± 0.2	404.9	259.2	10.0	9.7	4.0	0.3	2.6
8	8.5 ± 0.2	404.9	259.2	10.0	9.7	4.0	0.3	2.6
7	7.5 ± 0.2	404.9	259.2	10.0	9.7	4.0	0.3	2.6
6	6.5 ± 0.2	404.9	259.2	10.0	9.7	4.0	0.3	2.6
5	5.5 ± 0.2	404.9	259.2	10.0	9.7	4.0	0.3	2.6
4	4.5 ± 0.2	404.9	259.2	10.0	9.7	4.0	0.3	2.6
3	3.5 ± 0.2	404.9	259.2	10.0	9.7	4.0	0.3	2.6
2	2.5 ± 0.2	404.9	259.2	10.0	9.7	4.0	0.3	2.6
1	1.5 ± 0.2	324.1	259.2	10.0	9.7	4.0	0.3	2.6
0	0.5 ± 0.2	243.1	243.1	10.0	9.7	4.0	0.2	2.5

Other speeds available.

Shaded area designates speeds where stable speed function is inoperative.

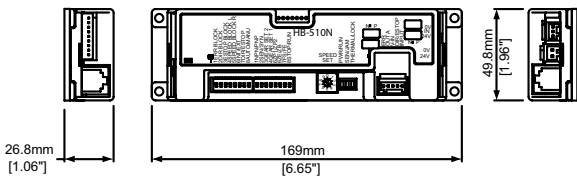

HB-510

MINIMUM TUBE LENGTH

Brake Option	Shaft Type	Groove Configuration	Minimum Tube Length (mm)		
			1 Stage gear	2 Stage gear	3 Stage gear
Non-Brake	Standard Threaded Hex	No Grooves	322	345	368
		35/22			
		50/32			
With Brake	Standard Threaded Hex	No Grooves	386	409	432
		35/22			
		50/32			

MOUNTING BRACKETS

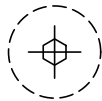

P-0C1 HEX POINT UP

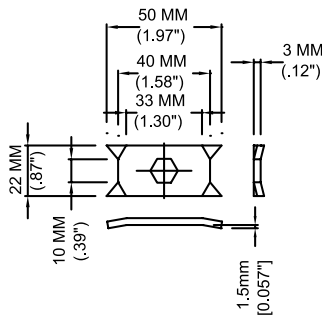

P-0B1 HEX FLAT UP

P-0B1 HEX FLAT UP



A-081-G HEX POINT UP

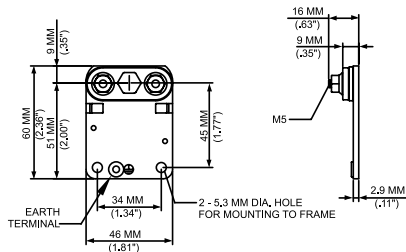

A-071-G HEX FLAT UP

A-071-G HEX FLAT UP



C-081 HEX POINT UP

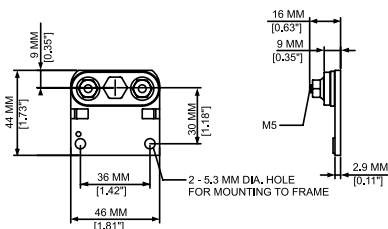

C-071 HEX FLAT UP

C-071 HEX FLAT UP